



# Melbourne and The Masters

## Final Scientific and Social Program

Pathology Update 2014 | 21 - 23 February 2014

Melbourne Convention Centre, South Wharf, Melbourne

**For a limited time in Melbourne**

Dr Steve Billings | Prof Marvin Fritzler | Prof Randy Gascoyne

Dr Elaine Mardis | Dr Stuart Smellie | Prof Mary Sheppard



#PathUpdate @PathologyRCPA



The Royal College of Pathologists of Australasia

[www.rcpa.edu.au](http://www.rcpa.edu.au)

[www.update2014.mobi](http://www.update2014.mobi)

### **Pathology Update 2014 Registration Desk Hours:**

Friday	21 February 2014	8.00am – 5.00pm
Saturday	22 February 2014	7.00am – 4.00pm
Sunday	23 February 2014	8.00am – 3.00pm

Secretariat: 101

Speakers Preparation: 101

Media Room: 104

Robing Rooms: 107-108

Industry Exhibition: Level 1

Scientific Sessions: Plenary 1 & Level 1

# Contents

<b>Welcome</b>	<b>2</b>
<b>Pathology Update 2014 Committees</b>	<b>3</b>
<b>Important Delegate Information</b>	<b>4</b>
<b>Pathology Update 2014 Partners</b>	<b>5 - 7</b>
<b>Pathology Update 2014 Exhibitors</b>	<b>8 - 17</b>
<b>Pathology Update 2014 Social Events</b>	<b>18</b>
<b>Masterclasses, Meetings and Industry Symposiums</b>	<b>19</b>
<b>Pathology Update 2014 Scientific Programs</b>	<b>20 - 25</b>
<b>MCEC Venue Locality &amp; Directions</b>	<b>26 - 27</b>

**To download speaker biographies, photos  
and abstracts please go to  
[www.update2014.mobi](http://www.update2014.mobi)**



# Welcome to Pathology Update 2014

## – Melbourne and the Masters

On behalf of the College Council, Pathology Update 2014 Overseeing Committee and the Scientific Program Committees, it is with great pleasure that we welcome you back to Melbourne and what promises to be an exciting three days of cutting edge research and updates in your discipline.

The scientific committees have worked extremely hard to develop an interesting, informative and entertaining program, and we hope we have managed to provide “something for everyone” – including fellows, trainees, scientists, and other healthcare workers. Pathology Update aims to be the best Australasian pathology multi-disciplinary scientific meeting.

We would also like to thank all our speakers for their hard work in preparing their presentations – we couldn’t do it without you!

We are proud to be hosting over 140 local and six international speakers who are leaders in their fields over a busy three day scientific program..

As well as enjoying the scientific sessions, please make the most of the opportunity to meet with colleagues and share issues of interest. Make new friendships and renew old ones at the Welcome Cocktail Party and join us for the pathology industry dinner of the year at The Melbourne Museum and find your inner James Bond.

We would like to thank our all our sponsors and exhibitors. This meeting could not take place without their continued financial support and we ask you to acknowledge their support by visiting all the booths on Level One.

We also recognise the continued support of the all the Major and Supporting Partners.

Pathology Update would not be possible without the support of our sponsors and exhibitors and we encourage you to visit each booth.

We want to congratulate the Chairs and the Members of the nine Scientific Program Committees that coordinate the program for Pathology Update 2014. We thank them for their dedication and commitment to Pathology Update and in advance acknowledge their contribution.

Enjoy your Masters!



A handwritten signature in black ink, appearing to read 'P. Stewart'.

**A/Prof Peter Stewart**  
**President**



A handwritten signature in black ink, appearing to read 'Ian Clark'.

**Dr Ian Clark**  
**Chair, Pathology Update 2014**  
**Overseeing Committee**

## Pathology Update 2014 Overseeing Committee

Dr Ian Clark - Chair  
Dr Damien Bruno  
A/ Prof Kevin Carpenter  
Ms Debbie Deston  
Dr Michael Dray  
Dr James D'Rozario

Dr Ian Gardner  
Dr Debra Graves  
Dr Peter Jessup  
Dr Neil Lambie  
Mr Wayne Mathews  
Dr Ben McGettigan

Ms Eve Propper  
Dr Wendy Pryor  
Dr Bronwen Ross  
Dr Helen Wordsworth

## Pathology Update 2014 Scientific Program Committees

### Anatomical Pathology

Dr Chris Hemmings - Chair  
Dr Inny Busmanis  
Dr Amanda Charlton  
Dr Margaret Cummings  
Dr Rohan Lourie  
Dr Andrew Ryan  
Dr Victoria Yachmenikova

### Chemical Pathology

Dr Que Lam - Chair  
A/Prof Tony Badrick  
Dr Cherie Chiang  
Dr Penelope Coates  
A/Prof Christopher Florkowski  
A/Prof Peter Hickman  
Prof Rita Horvath  
Dr Alan McNeil  
Ms Jill Tate

### Forensic Pathology

A/Prof Neil Langlois - Chair  
Dr Alanah Buck  
Dr Clive Cooke  
Prof Jo Duflou  
Dr Sarah Parsons  
Prof David Ranson  
Dr Martin Sage  
Dr Noel Woodford

### Genetic Pathology

Dr Melody Caramins - Chair  
A/Prof Bruce Bennetts  
Dr Dan Catchpoole  
Prof John Christodoulou  
A/Prof Roderick Clifton-Bligh  
Dr Michael Fietz  
Dr Barney Rudzki  
Prof Hamish Scott  
Prof Rodney Scott  
Prof Graeme Suthers  
Prof David Thorburn

### Haematology

Dr Bronwyn Williams - Chair  
Dr Tim Brighton  
Dr Amanda Davis  
Dr James D'Rozario  
Prof Joy Ho  
Dr Chris Hogan  
Dr Sueh Lim  
Dr Zoe McQuilten  
Dr Katherine Marsden  
Dr Joanne Perel  
Dr Huong Phan  
Prof John Rasko

### Immunopathology

Dr David Gillis - Chair  
Dr Stephen Adelstein  
Dr Sharon Choo  
Dr Dominic Mallon  
Dr Kate Nicholls  
Dr Katrina Randall  
Mr Robert Wilson  
Dr Richard Wong

### Microbiology

Dr Harsha Sheorey - Chair  
Dr Joan Faoagali  
Dr Chris Hewison  
Dr Sasha Jaksic  
A/Prof Monica Lahra  
Dr Chris Mansell  
Dr Brendan McMullan  
Dr Arthur Morris  
Dr Robert Norton  
A/Prof Mary-Jo Waters

### Oral & Maxillofacial

A/Prof Richard Logan - Chair  
A/Prof Hedley Coleman  
Prof Jane Dahlstrom  
Dr Norman Firth  
Prof Newell Johnson  
Prof Alfred Lam  
Prof Greg Seymour  
Dr Anna Talacko

### Paediatric

Dr Adrian Charles - Chair  
Dr Susan Arbuckle  
Dr Lavinia Hallam  
Dr Diane Payton

# Pathology Update 2014 Delegate Information

## Pathology Update 2014 App

Check out the Pathology Update 2014 APP on any smart phone or tablet by entering this url: [update2014.mobi](http://update2014.mobi) into the address bar in your browser. Please see the app for all speaker abstracts, bios and photos and to view program by time and track. Visit the App Concierge Lauren at the registration desk if you have any questions. There is complimentary WiFi at the Melbourne Convention Centre.

## MCEC Wireless Internet Access

This services requires individual users to subscribe (free of charge) to the service via a login page agreeing to a set of terms and conditions. Individual users will need to re-subscribe (free of charge) to the service after 12 hours or once the 100MB download limit is reached.

## How to access the service

Connecting to the wireless network will be different depending upon the device being used.

Delegates will need to complete the following steps:

1. Select the MCONNECT wireless service as they would normally do using their wireless device
2. Open their preferred internet browser (safari, Firefox, explorer etc.)
3. Complete the information on the log-in page that will appear in their browser (see below).
4. Select 'Generate Account'
5. Select 'Login' on the guest account page
6. Read the terms and conditions page and choose accept in order to connect.
7. Commence using MConnect

## Certificate of Attendance

A Certificate of Attendance has been provided for all attendees at Pathology Update 2014 in the Pathology Update 2014 Delegate Bag.

## Electronic Devices

Pathology Update 2014 would greatly appreciate all electronic devices (mobile phones, pagers, pocket pc and blackberries) to be on "silent" during session times. Visual and or audio recording of any scientific sessions is strictly prohibited.

## Media s2i Communications [www.s2i.com.au](http://www.s2i.com.au)

Linsey Brown Senior Account Director & GM	S2i Communications 02 9231 2927	<a href="mailto:Linsey@s2i.com.au">Linsey@s2i.com.au</a> 0425 514 005
Georgy Searles Account Manager	S2i Communications 02 9231 2927	<a href="mailto:Georgy@s2i.com.au">Georgy@s2i.com.au</a> 0417 764 587

## Messages

All messages received during the event will be displayed on the message board near the registration desk.

## Lanyard

All delegates will be given a neck wallet on registration. Please wear your neck wallet at all times during the conference, as it is the official entrance pass to all sessions, exhibition area, teas and lunches each day.

## Location and Venue

The Melbourne Convention Centre is located at South Wharf, Melbourne.

## Pathology Update 2014 Registration Desk Hours:

- |                             |                 |
|-----------------------------|-----------------|
| ● Friday 21 February 2014   | 8.00am – 5.00pm |
| ● Saturday 22 February 2014 | 7.00am – 4.00pm |
| ● Sunday 23 February 2014   | 8.00am – 3.00pm |

Secretariat: 101 | Speakers Preparation: 101 | Media Room: 104 | Robing Rooms: 107-108

Industry Exhibition: Level 1 | Scientific Sessions: Plenary 1 & Level 1

## Pathology Update 2014: Post Conference CD

A CD is being produced for Pathology Update 2014 which will contain the presentations (where permitted by speakers). Please note this CD will be mailed to delegates after the event (and will not contain audio), and will be sent to all registered Pathology Update 2014 delegates by May 2014.

## Surveys

Available on the RCPA website [www.rcpa.edu.au](http://www.rcpa.edu.au) will be an electronic survey for all delegates to complete.

## Disclaimer

Details provided in this brochure are for information only and are expressly excluded from all and any legal document. To the best of the knowledge and information of the RCPA and its representatives, all facts, information and figures contained in this brochure and attachments are true and accurate at the time of printing. The RCPA reserves the right to make any changes to topics, contents and presenters as it may deem necessary, without prior notice and disclaims, to the fullest extent permitted by law, all and any liability to any person, persons or organisation either directly or indirectly

# Pathology Update 2014 Partners

## Major Partner

---

### Sonic Healthcare

Sonic Healthcare is an international healthcare company focused on delivering quality, independent services in medical diagnostics and multidisciplinary medical practices.

Our Services include:

- Pathology
- Radiology
- Medical centres
- Occupational and insurance medical services
- Clinical trials
- Food and water testing

Our company is structured as a decentralised federation of medically-led practices, with our head office located in Sydney, Australia. We employ 26,000 people in Australia, New Zealand, the United Kingdom, Germany, Switzerland, Belgium, Ireland and the USA.

We are recognised for our dedication to our staff, our quality and services excellence.

#### Contact Details:

Address: 14 Giffnock Avenue, Macquarie Park NSW 2113  
Tel: 61 2 98 555 222 | Fax: 61 2 98 555 111  
Web: [www.sonichealthcare.com](http://www.sonichealthcare.com)



## APP Partner

---

### Siemens Ltd

Siemens Healthcare is one of the world's largest suppliers to the healthcare industry and a trendsetter in medical imaging, laboratory diagnostics and medical information technology. Siemens in Australia and New Zealand is committed to provide innovative solutions for accessible, high quality and preventative healthcare, now and in the future.

#### Contact Details:

Name: Michael Meyer  
Address: 885 Mountain Highway, Bayswater VIC 3153  
Tel: 61 2 9491 5937  
Email: [michael.mime.meyer@siemens.com](mailto:michael.mime.meyer@siemens.com)  
Web: [www.siemens.com.au/healthcare](http://www.siemens.com.au/healthcare)

## Supporting Partners

---

### BDO

BDO is one of the largest full service accounting and advisory networks in Australia and globally. We excel at creating strong relationships with clients who are seeking a combination of technical excellence with a specialised range of services and a desire for outstanding client relationships.

#### Contact Details:

Name: John Bresolin  
Address: Level 11, 1 Margaret Street, Sydney NSW 2000  
Tel: 61 9251 4100 | Fax: 61 9240 9821  
Email: [john.bresolin@bdo.com.au](mailto:john.bresolin@bdo.com.au)  
Web: [www.bdo.com.au](http://www.bdo.com.au)



### City of Melbourne

The City of Melbourne is a capital city local government that strives to achieve the community's vision of Melbourne as a bold, inspirational and sustainable city – a great place for people to live and visit. Melbourne is also recognised as a knowledge city where innovation and technology are understood and supported. We are proud to support the annual Pathology Update in 2014.

#### Contact Details:

Tel: 61 3 9658 9658  
Web: [www.melbourne.vic.gov.au](http://www.melbourne.vic.gov.au)



### Dorevitch Pathology

Dorevitch Pathology is a leading provider of pathology and medical diagnostic services to doctors, specialists and hospitals throughout Victoria, as well as commercial and Government organisations in Australia and internationally. Dorevitch Pathology provides services to over 70 private and public hospitals in Melbourne and regional Victoria / New South Wales. Additionally, services to community based patients are provided with over 350 Collection Centres and a network of 30 laboratories spread throughout these regions. We offer a pathology service which provides superior quality, speed and convenience of service, via the most modern facilities and processes, highly trained and experienced staff and Pathologist consultation covering all medical disciplines.

#### Contact Details:

Name: Elda Rebecchi , Manager Communications  
Address: 18 Banksia Street, Heidelberg VIC 3084  
Tel: 61 3 92440270 | Fax: 61 3 92440432  
Email: [elda.rebecchi@dorevitch.com.au](mailto:elda.rebecchi@dorevitch.com.au)  
Web: [www.dorevitch.com.au](http://www.dorevitch.com.au)





## Healthscope Pathology

Healthscope Pathology's goal is to lead the way in providing superior pathology services to health practitioners and their patients.

Our focus is to deliver a prompt and professional service through our team of specialist pathologists, dedicated scientific team and reliable operational staff.

We specialise in:

- General Pathology
- Molecular & Advanced Pathology
- Pharmacogenomics & Cytogenetics
- Functional Pathology
- Commercial Pathology

### Contact Details:

Name: Sales & Marketing Department  
Address: 1868 Dandenong Road, Clayton VIC 3168  
Tel: 61 3 9538 6777 | Fax: 61 3 9538 6778  
Web: [www.healthscopepathology.com.au](http://www.healthscopepathology.com.au)



---

## Norton Rose Fulbright Australia

Norton Rose Fulbright's global life sciences and healthcare team advises a range of innovative pharmaceutical, medical device and biotechnology companies as well as investors in the sector. We provide cutting-edge advice on the full range of legal issues that arise in the sector, from regulatory and compliance strategy through to patent litigation and corporate transactions.

### Contact Details:

Name: Bernard O'Shea  
Address: GPO Box 4592SS Melbourne VIC 3001  
DX: 445 Melbourne Level 15, RACV Tower, 485 Bourke Street, Melbourne VIC 3000  
Tel: 61 3 8686 6573 | Fax: 61 3 8686 6505  
Email: [bernard.oshea@nortonrosefulbright.com](mailto:bernard.oshea@nortonrosefulbright.com)  
Web: <http://www.nortonrosefulbright.com>



# Pathology Update 2014 Exhibitors - Level One

## Abbott Laboratories

### Booth Number: 30 - 31

Abbott Diagnostics goes beyond tests and instruments; we can offer you a solution from consulting and informatics to customised automation, we'll work with you to develop the right business solution.

Abbott Molecular- an emerging leader in molecular diagnostics. We assist in earlier diagnoses of disease, selection of appropriate therapies and improved monitoring of disease progression

### Contact Details:

Name: Vicki Neal (Diagnostics) / Gideon Sauer (Molecular)  
Address: Suite D, 31-33 Sirius Rd, Lane Cove NSW 2066  
Tel: 61 2 9857 1111 | Fax: 61 2 9857 1122  
Email: Vicki.Neal@abbott.com / Gideon.Sauer@abbott.com  
Web: www.abbottdiagnostics.com.au



## AstraZeneca

### Booth Number: 2

AstraZeneca Australia, based in North Ryde, Sydney, is the largest pharmaceutical company operating in Australia. AstraZeneca employ almost 1,000 people, are one of the country's largest manufacturers of medicines and are a key exporter to 35 international markets.

AstraZeneca manufactures 100 separate product lines, namely sterile respiratory and local anaesthetic products. Of the top twenty medicines used in Australia, four are made by AstraZeneca. AstraZeneca produces medicines in six separate therapeutic areas including cancer, cardiovascular, gastrointestinal, infection, neuroscience and respiratory inflammation. AstraZeneca contributes significantly to clinical trials in Australia with approximately 30 concurrent trials in 190 sites across the country.

### Contact Details:

Address: 5 Alma Road, North Ryde NSW 2113  
Tel: 61 2 9978 3500 | Fax: 61 2 9978 3700  
Web: www.astrazeneca.com.au



## Beckman Coulter - Pathology Update 2014 Major Partner

### Booth Numbers: 16 - 18

Beckman Coulter develops, manufactures and markets products that simplify, automate and innovate complex biomedical testing. For more than 75 years, Beckman Coulter's products have been making a difference in peoples' lives by improving the productivity of medical professionals and scientists, supplying critical information for improving patient health and reducing the cost of care.

### Contact Details:

Name: Moira Rooney, Product Manager  
Address: 23-27 Chaplin Drive, Lane Cove NSW 2066  
Tel: 02 9844 6000 | Fax: 02 9844 6096  
Email: sales\_aust\_nz@beckman.com  
Web: www.beckmancoulter.com



## BD

### Booth Number: 35 - 36

BD is a leading global medical technology company that develops, manufactures and sells medical devices, instrument systems and reagents. The Company is dedicated to improving people's health throughout the world. BD is focused on improving drug delivery, enhancing the quality and speed of diagnosing infectious diseases and cancers, and advancing research, discovery and production of new drugs and vaccines. BD's capabilities are instrumental in combating many of the world's most pressing diseases. Founded in 1897 and headquartered in Franklin Lakes, New Jersey, BD employs approximately 28,000 people in approximately 50 countries throughout the world. The Company serves healthcare institutions, life science researchers, clinical laboratories, the pharmaceutical industry and the general public.

#### Contact Details:

Name: Sandra Viladecas  
Address: 4 Research Park Dr, West Ryde NSW 2113  
Tel: 61 2 8875 7029  
Email: sandra\_viladecas@bd.com  
Web: www.bd.com



## Cirdan Ultra & Cirdan Imaging

### Booth Numbers: 23 - 24

Cirdan Ultra Limited is a world leading provider of laboratory information management systems. The Ultra laboratory system is installed widely across Australia, APAC, North America, and Europe.

Cirdan Imaging Limited is engaged in the design, manufacture and supply of innovative medical imaging technology for the diagnosis and management of disease.

#### Contact Details:

Name: Dave Crockett  
Address: Unit 4 Crescent Business Park, Ballinderry Road,  
Lisburn, BT28 2GN, Northern Ireland  
Tel: 61 2 4036 3075  
Email: dcrockett@cirdanultra.com  
Web: www.cirdanultra.com & www.cirdanimaging.com



## Cleveland Clinic Abu Dhabi

### Booth Number: 25

Cleveland Clinic Abu Dhabi is a world-class multispecialty hospital, currently under construction in Abu Dhabi, UAE. This 364-bed facility will be an unparalleled extension of the Cleveland Clinic model of care, specifically designed to address a range of complex and critical care requirements unique to the Abu Dhabi population.

#### Contact Details:

Name: Joe Friz, Director, Clinical Recruitment, Cleveland Clinic Abu Dhabi  
Address: P.O. Box 112412, Abu Dhabi, United Arab Emirates  
Tel: Office: +97124108303 | Mobile: +971506161592  
Email: frizj@clevelandclinicabudhabi.ae  
Web: www.clevelandclinicabudhabi.ae



## Diagnostic Solutions

### Booth Number: 32

Diagnostic Solutions is a leading supplier of high quality, innovative systems for diagnostic pathology laboratories across Australia and New Zealand. View a demonstration of the Immuno Concepts Image Navigator®, an automated immunofluorescence system

Address: 46 Albert Street, Preston VIC 3072  
Tel: 61 3 8470 5400 | Fax: 61 3 8470 5490  
Australia: 1300 788 003  
New Zealand: 0800 448 018  
Email: [info@diagnosticsolutions.com.au](mailto:info@diagnosticsolutions.com.au)  
Web: [www.diagnosticsolutions.com.au](http://www.diagnosticsolutions.com.au)



## Diasorin Australia Pty Ltd - Pathology Update 2014- Major Partner Sponsor of the Welcome Cocktail Party

### Booth Number: 33 - 34

DiaSorin is a specialist supplier in the areas of immunoassay and molecular testing for the in vitro diagnostic market. DiaSorin offers a broad range of high quality assays that include comprehensive panels for each of the clinical segments in which it operates: infectious and viral diseases, management of bone and calcium related diseases, thyroid pathologies, oncology and endocrinology. On display at Pathology Update will be the new Liaison Iam with Q-LAMP technology for molecular testing of viral pathogens and oncohaematology markers.

### Contact Details:

Name: Diasorin Australia Pty Ltd  
Address: Suite 3, Level 3, 68 Waterloo Road, North Ryde NSW 2113  
Australia: 1300 259 835  
New Zealand: 0508 848 660  
Email: [sales@diasorin.com.au](mailto:sales@diasorin.com.au)  
Website: [www.diasorin.com](http://www.diasorin.com)



## FE Technologies Pty Ltd

### Booth Number: 4

FE Technologies works with pathology labs to create a streamlined tracking process – with RFID samples can be read instantly at various points from sample collection to the laboratory. The incidence of misplaced samples will be drastically reduced, and a range of valuable reporting allows you to know exactly where any given sample is at any time.

### Contact Details:

Name: Peter Ferendinos, Business Development Executive  
Address: P.O. Box 318, Belmont VIC 3216  
Tel: 61 1300 731 991 | Fax: 61 1300 790 662  
Email: [enquiries@fetechgroup.com](mailto:enquiries@fetechgroup.com)  
Web: [www.FETechGroup.com](http://www.FETechGroup.com)



## Helena Laboratories

### Booth Number: 19

Helena Laboratories (Australia) Pty. Ltd. has been providing electrophoresis supplies and haemostasis products to Australian laboratories for over 30 years. Whether you require protein electrophoresis or specialized platelet function testing, Helena offers a broad range of instrumentation and reagents. Our portfolio includes both stand alone and Point of Care instruments. We cater to the clinical, life sciences and vet laboratories. To supplement our products we provide specialist technical and consultative services to our customers. Helena Laboratories offers an extensive range of complimentary educational resources. Please call by our display to ask for any that may be of interest to you.

#### Contact Details:

Name: Joanne Mercuri  
Address: PO Box 340, Mt Waverley VIC 3149  
Tel: 61 3 9543 7299 | Fax: 61 3 9543 7542  
Email: sales@helena.com.au  
Web: www.helena.com.au



## Hologic

### Booth Number: 21

HOLOGIC is a global leader in the development, manufacture and marketing of products and services used in screening and diagnosis within the area of Public / Womens Health and Blood Banking. Our products and technologies cover molecular diagnostics, surgical, mammography and gynaecology to focus on providing better patient management.

#### Contact Details:

Name: Nicolle Trivett-Moore (Senior Manager, Sales and Marketing – Molecular Diagnostics)  
Address: Suite 402, 4th Floor, 2-4 Lyon Park Rd, Macquarie Park NSW 2113  
Tel: 61 2 9888 8000 | Fax: 61 2 9870 7555  
Email: nicolle.trivett-moore@hologic.com



## Howden Medical Books Pty Ltd

### Booth Number: 40

Howden Medical Books has been a regular attendee at Pathology Update and this year is no different. We will have a wide range of pathology titles on display and this is a great chance to have a browse and buy a book or two. Our booth has moved from last year and we are now by the entranceway to the Hilton Hotel, but please check the floor plan if you have trouble spotting us.

#### Contact Details:

Name: Tim Leask  
Address: 9 Irvine St, Mitcham VIC 3132  
Tel: 61 1300 455 778 | Fax: 61 1300 644 310  
Email: sales@howmed.com.au  
Web: www.howmed.com.au



## Illumina

### Booth Number: 13

Advancements in our understanding of genetics have the potential to change the practice of medicine and enable genomics-based healthcare. With streamlined workflows and advanced informatics, Illumina sequencing and array technologies are allowing you to explore the genome in increasing detail. Leveraging genetic information in a clinical environment will lead to better patient care through personalised medicine

#### Contact Details:

Name: Janelle Allen  
Address: 1 International Court, Scoresby VIC 3179  
Tel: 61 3 9212 9900 | Fax: 61 3 9212 9901  
Email: [jallen@illumina.com](mailto:jallen@illumina.com)  
Web: [www.illumina.com](http://www.illumina.com)



## Integrated Sciences Pty. Ltd.

### Booth Number: 3

Integrated Sciences is an Australian owned business that supplies both the Australian Diagnostics and Life Science markets. We specialize in Molecular Diagnostics, Immunology, Point Of Care and Genomics. "Our strategy is support" and we pride ourselves in offering quality products with the highest levels of technical support, service and performance.

#### Contact Details:

Name: Dylan warby  
Address: 54 Gibbes St, Chatswood, NSW 2067  
Tel: 61 2 9417 7866 | Fax: 61 2 9417 5066  
Email: [dwarby@integratedsci.com.au](mailto:dwarby@integratedsci.com.au)  
Web: <http://www.integratedsci.com.au/>



## Leica Biosystems Pty Ltd

### Booth Number: 26

Leica Biosystems is a global leader in workflow solutions bringing histopathology laboratories and researchers the highest quality, most comprehensive product range in anatomical pathology. With complete histology systems featuring innovative automation, Novocastra™ reagents and Surgipath® consumables, Leica Biosystems offers the ideal product for each histology step and high-productivity workflow solutions for the entire laboratory.

#### Contact Details: Leica Biosystems Pty Ltd

Name: Kevin Balzarolo: Clinical Diagnostics Manager - ANZ  
Address: Unit 3, 112-118 Talavera Road, North Ryde NSW 2113  
P O Box 526, North Ryde BC NSW 1670  
Tel: 61 2 8870 3526 | Fax: 61 2 9878 1055  
Email: [Kevin.Balzarolo@leicabiosystems.com](mailto:Kevin.Balzarolo@leicabiosystems.com)  
Web: [www.leicabiosystems.com](http://www.leicabiosystems.com)



## Novartis

### Booth Number: 22

Novartis is caring and curing. We are committed to the research, development and supply of medicines to prevent and cure disease, ease suffering and enhance quality of life. To find out more about who Novartis is, visit [www.novartis.com.au](http://www.novartis.com.au).

#### Contact Details:

Name: Gary Maclachlan – Leukaemia Portfolio Lead  
Address: 54 Waterloo Rd, North Ryde NSW 2113  
Tel: 61 2 9805 3555



## Olympus

### Booth Number: 5 - 6

As a world-wide renowned manufacturer of microscopes, Olympus supplies high quality microscopes to the research and clinical markets with a range that provides industry leading optics and image clarity. Olympus provides equipment that covers a wide range from educational microscopes to the highest quality research grade confocal equipment, the breadth and quality of equipment makes Olympus a supplier of choice for any microscope or imaging requirement.

#### Contact Details:

Name: Warwick Dellow  
Address: 3 Acacia Place, Notting Hill VIC, 3168  
Tel: 0428 559 642 | Fax: 61 3 9562 6416  
Email: [warwick.dellow@olympus.com.au](mailto:warwick.dellow@olympus.com.au)  
Website: [www.olympusaustralia.com.au](http://www.olympusaustralia.com.au)



## Pacific Knowledge Systems

### Booth Number: 29

PKS RippleDown software integrates with the LIS to enhance the overall performance of the laboratory by reducing errors, improving workflow and providing patient centric reporting. Our suite of products are deployed globally and are supported 24/7 by our dedicated team who are committed to delivering service excellence.

#### Contact Details:

Name: Paul Williams  
Address: Suite 309, 50 Holt Street, Surry Hills NSW 2010  
Tel: 61 2 8313 9990 | Fax: 61 2 8399 2178  
Email: [p.williams@pks.com.au](mailto:p.williams@pks.com.au)  
Web: [www.pks.com.au](http://www.pks.com.au)



## Pathology Awareness Australia

### Booth Number: 7

Know Pathology Know Healthcare is an initiative by Pathology Awareness Australia (PAA) to improve recognition of the value of pathology. PAA is an industry wide body comprising representation from RCPA, IVD Australia, NCOP, Pathology Australia and private pathology laboratories. Show you value pathology and sign up at [www.knowpathology.com.au](http://www.knowpathology.com.au)

#### Contact Details:

Name: John Emmerson  
Address: c/o London Agency Pty Ltd, Level 1,  
40 Porter Street, Prahran VIC 3181  
Tel: 61 3 9982 4450  
Email: [info@knowpathology.com.au](mailto:info@knowpathology.com.au)  
Web: [www.knowpathology.com.au](http://www.knowpathology.com.au)



## PerkinElmer

### Booth Number: 27

PerkinElmer is a premier provider of cutting-edge technologies and solutions enabling researchers to create more efficient and quicker life-saving and enhancing medicines and diagnostic tests. As a leading solutions innovator, PerkinElmer bridges the gap between in vitro assays and in vivo results, allowing researchers to translate their results into cures for human disease.

#### Contact Details:

Name: Christine Mylo  
Address: Lvl 2, Bldg 5, Brandon Office Park,  
530-540 Springvale Road, Glen Waverley VIC 3150  
Tel: 1800 033 391 | Fax: 61 3 9212 8595  
Email: [Christine.Mylo@perkinelmer.com](mailto:Christine.Mylo@perkinelmer.com)  
Web: <http://www.perkinelmer.com/lifesciences>



## Pixcelldata showcased by Perfekt Pty Ltd

### Booth Number: 20

Perfekt is a solution provider offering end-to-end Digital Pathology systems. Our pedigree stems from IT integration. We simplify the complexity of a Digital Pathology initiative through our ability to offer everything from scanners, Collibio image viewing/management software, IT servers and storage, monitors, networking, quality assurance, LIS integration and implementation services.

#### Contact Details:

Name: Craig Tamlin  
Address: 5 Nisbet Road, Applecross WA 6153  
Tel: 61 8 9364-8881  
Email: [craig.tamlin@perfekt.com.au](mailto:craig.tamlin@perfekt.com.au)  
Web: <http://www.perfekt.com.au/solutions/digital-pathology>





## Qiagen

### Booth Number: 15

QIAGEN provides solutions from sample to result for companion diagnostics (oncology), infectious disease and transplantation testing, and detection of sexually transmitted diseases and latent tuberculosis. At QIAGEN, we strive to provide products that enable private and public facilities, hospitals and community clinics, and pathology and immunology labs to provide efficient and reliable diagnoses for patients based on clinical value.

#### Contact Details:

Name: Florence Aimonetti  
Address: PO Box 169, Chadstone Centre VIC 3148  
Tel: 1 800 243 800 | Fax: 61 3 9840 9888  
Email: orders-au@qiagen.com  
Web: www.qiagen.com



## Randox Laboratories

### Booth Number: 9

With over 30 years' experience, Randox provide the highest quality diagnostic solutions. Our product portfolio includes clinical chemistry and immunoassay analysers, multiplexing biochip array technology, high quality reagents, quality control material and the largest global EQA scheme in the world. The range also extends into life sciences and molecular diagnostics.

#### Contact Details

Name: Nicole McKeown  
Address: 2/4 Charles Street, Parramatta NSW 2150  
Tel: 61 2 9615 4640 | Fax: 61 2 9615 4644  
Email: marketing@randox.com



## Royal College of Pathologists of Australasia

### Booth Number: 39

The Royal College of Pathologists of Australasia (RCPA) is present at Pathology Update 2014 to promote the RCPA Foundation, which is committed to funding initiatives that help us gain a greater understanding of the causes of disease and provide further research opportunities for trainees, scientists and fellows. Come along to the RCPA exhibitor booth during morning tea, lunchtime and afternoon tea (Friday and Saturday) to preview the new RCPA website. We will be showcasing RCPA Education Online's educational resources and the new virtual microscopy eCases library amongst other sections of the site. If you have any website related queries, let us answer it today or take this opportunity to provide your feedback or suggestions to us in person. The President of the RCPA is Prof Peter Stewart and the Chief Executive Officer is Dr Debra Graves. The College is a not-for-profit organisation. More information can be obtained from our website [www.rcpa.edu.au](http://www.rcpa.edu.au)

#### Contact Details:

Name: Eve Propper  
Address: 207 Albion St, Surry Hills NSW 2010  
Tel: 02 8356 5806 | Fax: 02 8356 5828  
Email: evep@rcpa.edu.au  
Web: www.rcpa.edu.au



## RCPA Quality Assurance Programs - Pathology Update 2014 Major Partner

### Booth Numbers: 37 - 38

RCPA Quality Assurance Programs is one of the world's leading external quality assurance and education program providers to public and private pathology laboratories. Programs are provided in all disciplines of pathology. Each program is individually accredited by NATA and complies with the requirements of ISO/IEC 17043:2010.

#### Contact Details:

Name: Paul Cohen, General Manager Operations  
Address: Suite 201/Level 2, 8 Herbert Street, St Leonards NSW 2065  
Tel: 61 2 9045 6000 | Fax: 61 2 9356 2003  
Email: paul.cohen@rcpaqap.com.au  
Web: www.rcpaqap.com.au



## Roche – Pathology Update 2014 Major Partner - Internet Cafe

### Booth Number: 41

At Roche, Innovating Healthcare is at the core of our business strategy through Leading Pathology Solutions and Supporting Patient Management. Our expanding knowledge and understanding of disease mechanisms leads us to deliver significant benefits to patients and healthcare professionals.

Please visit the Roche internet café and view and talk to the team over a coffee:

- Digital Pathology for slide scanning, data management and collaboration
- cobas® Pathology solutions for your laboratory, including our fully automated AMH assay

Roche will also provide a coin donation box at the coffee stand for anyone wishing to donate towards Lymphoma Australia.

#### Contact Details:

Name: Jenny Hamilton  
Address: 31 Victoria Avenue, Castle Hill NSW 2154  
Tel: 61 2 9860 2222 | Fax: 61 2 9860 2111  
Email: jenny.hamilton.jh2@roche.com  
Web: www.roche.com / www.ventana.com



## Sapphire Bioscience

### Booth Number: 14

Abcam plc is a provider of protein research tools and services, with an unrivalled range of products and expert technical support, enabling scientists to analyse living cells at the molecular level and improving the understanding of health and disease. Abcam is distributed by Sapphire Bioscience in Australia and New Zealand.

#### Contact Details:

Name: Debra Kiss  
Address: 126 Cope St, Waterloo NSW 2017  
Tel: 61 2 9698 2022 | Fax: 61 2 9698 1022  
Email: sales@sapphirebioscience.com  
Web: www.abcam.com; www.sapphirebioscience.com



## Sarstedt Australia

### Booth Number: 8

Founded in 1961 with international headquarters located in Germany; the Sarstedt group employs almost 2,500 people and is a leader manufacturer of diagnostic, laboratory and medical products. Our range includes both equipment and consumables for use in pathology, laboratory, research, transfusion medicine, blood banking, hospital, pharmaceutical, forensic and industrial applications.

#### Contact Details:

Name: Justin Pickering  
Address: 16 Parkway. Mawson Lakes. SA 5095  
Tel: 61 8 8349 6555 | Fax: 61 8 8349 6882  
Email: info.au@sarstedt.com  
Web: www.sarstedt.com



## Sequenom Bioscience

### Booth Number: 1

Sequenom is committed to providing the best genetic analysis solutions for the research and molecular diagnostic markets.

#### Contact Details:

Name: Jeff Bryant  
Address: Level 6, CBCRC, 300 Herston Road, Herston QLD 4006  
Tel: +61 7 3088 1600 | Fax: +61 7 3088 1614  
Email: sales-asiapacific@sequenom.com  
Web: www.sequenom.com



## Sysmex

### Booth Number: 28

Sysmex is a frontrunner in lab technology. The Delphic LIS suite is a leading pathology system which meets the needs of all disciplines. A user-friendly, modern LIS, Delphic accurately streamlines the flow of information from pre-analytical to post-analytical, completed with electronic order front end and advanced reporting.

#### Contact Details:

Name: Noel Paggao  
Address: PO Box 26085, Epsom, Auckland 1344, New Zealand  
Tel: 61 3 9013 4445 | Fax: 64 9 630 8135  
Email: Paggao.noel@sysmex.com.au  
Web: www.sysmex.com.au



## Wolters Kluwer Health | Lippincott Williams and Wilkins

### Booth Number: 12

A leading international publisher of books, journals and digital products for healthcare professionals and students, LWW is the exclusive publisher of the RCPA's journal Pathology which is now available on the iPad®. Pathology Network (www.pathnetwork.com) is an online solution for full-text access to every current article from LWW pathology journals.

#### Contact Details:

Name: Jon Muir, Journals Marketing  
Address: 250 Waterloo Road, London SE1 8RD, UK  
Tel: +44 (0)20 7981 0600 | Fax: +44(0)20 7981 0601  
Email: jon.muir@wolterskluwer.com  
Web: www.lww.com



Lippincott Williams & Wilkins

# Pathology Update 2014 Social Events and Admission of New Fellows and Awards Ceremony

## Welcome Cocktail Party - Shaken not stirred

**Date:** Friday 21 February 2014  
**Time:** 6.00pm - 7.30pm  
**Venue:** Level One, Melbourne Convention Centre amongst the Industry Exhibition  
**Dress:** Smart Casual

Find your inner James Bond and have your photo taken with James Bond!

Proudly sponsored by DiaSorin



For dinner options after the Welcome Cocktail Party please go to <http://southwharfpromenade.com.au>



## RCPA Annual Admission of New Fellows and Awards Ceremony - All Welcome

**Date:** Saturday 22 February 2014  
**Time:** 6.00pm - 7.00pm  
**Venue:** Plenary One, Melbourne Convention Centre  
**Dress:** Lounge Suit  
**Admission:** All delegates are invited to attend.  
**Entry:** From 5.40pm: (Fellowship and Award recipients will be contacted in advance with regard to arrival time and assembly points)  
**Robing Rooms:** Fellows - 107 | Trainees - 108

## Pathology Update 2014 Conference Dinner at the Melbourne Museum

**Date:** Saturday 22 February 2014  
**Time:** 7.30pm - 11.30pm  
**Venue:** Melbourne Museum - 11 Nicholson St Carlton Melbourne  
**Dress:** A Touch of Bond - Licensed to Thrill

**Transport to Melbourne Museum:** Sita Coaches will transport guests between 7.00 - 7.15pm outside the front entrance of the Hilton Hotel/MCEC Coach at the conclusion of the RCPA Awards and Admission Ceremony.

**Tram:** On Clarendon St, Tram 86 towards East Brunswick. Please disembark from the tram at Stop Number 12 (Melbourne Museum)

<http://ptv.vic.gov.au/getting-around/maps/metropolitan-trams/view/1041>

**Parking:** <http://museumvictoria.com.au/melbournemuseum/visiting/car-park/>

**Transport back to the Hilton Hotel From Nicholson St:** Sita Coaches will stagger from 10.30 to 11.30pm from to the Hilton Hotel/MCEC Coach Bay. This will be the only coach stop on the way back delegates staying at other hotels, please walk from the Hilton Hotel.

**Tram:** From Melbourne Museum, catch Tram 86 towards St Kilda Beach.

Please disembark from the tram at Stop Number 124A (Casino, MCEC)

<http://ptv.vic.gov.au/getting-around/maps/metropolitan-trams/view/1041>



Sean Connery relaxes on the bumper of his Aston Martin DB5 during the filming of location scenes for 'Goldfinger' in the Swiss Alps. Copyright Notice - © 1964 Danjaq, LLC and United Artists Corporation. All rights reserved.

## Rosé and Sparkling Closing Drinks

**Date:** Sunday 23 February 2014  
**Time:** 3.00pm - 4.00pm  
**Venue:** Level One, Melbourne Convention Centre amongst the Industry Exhibition  
**Dress:** Smart Casual



# Pathology Update 2014 Masterclasses, Meetings and Industry Symposia

Date	Time	Meeting	Room
Friday 21 February	12.00 - 1.00pm	Faculty of Science AGM (Open)	109
Friday 21 February	12.00 - 1.00pm	Trainees Forum (Open)	110
Friday 21 February	6.00 - 7.00 pm	BPS Angoff panel meeting (Closed)	108
Saturday 22 February	7.00 - 9.00am	CanSac (Closed)	107
Saturday 22 February	8.00-10.00am	FOMP Odonatology Committee Meeting	103
Saturday 22 February	12.30 - 1.30pm	Developing Communities Working Party Forum (Open)	103
Saturday 22 February	12.30 - 1.30pm	Chemical AC (Open)	105
Saturday 22 February	12.30 - 1.30pm	Cytopathology Committee (Closed)	107
Saturday 22 February	12.30 - 1.30pm	Forensic AC (Open)	106
Saturday 22 February	12.30 - 1.30pm	Haematology AC (Closed)	109
Saturday 22 February	12.30 - 1.30pm	Microbiology AC (Open)	110
Saturday 22 February	12.30 - 1.30pm	Paediatric Committee (Closed)	101/102
Saturday 22 February	12.30 - 1.30pm	Sonic Healthcare Lunch - Invitation Only 	207
Saturday 22 February	12.30 - 1.30pm	Editorial Journal Board Meeting	108
Sunday 23 February	8.00 - 10.00am	FOMP Committee Meeting	103
Monday 24 February	9.00 - 12.00pm	RCPA Board Meeting - For Board Members Only	206
Monday 24 February	9.00 - 3.30m	RCPA Trainee Induction Day	205
Monday 24 February	12.00-2.00pm	Pathology Update Think Tank - Invitation Only	207

# Friday 21 February 2014 Scientific Program

Time	Anatomical		Chemical	Forensic
9:00am – 9.45am	RCPA hosted Medical and Science Students Welcome Breakfast <b>103</b>			
9:00am – 10:00am	Meet the Chief Examiners - AP A/Prof Elizabeth Salisbury A/Prof Jurgen Stahl <b>Plenary 1</b>	Meet the Chief Examiner- General Pathology Dr Gordon White <b>107</b>	Meet the Chief Examiner Dr Penny Coates <b>105</b>	Meet the Chief Examiner Dr Chris Lawrence <b>106</b>
10.00am - 10.30am	Morning Tea on Level One amongst the Industry Exhibition and Roche Scientific Poster Display			
10.30am - 12.00pm	Examination Review Dr David Clift Prof Alfred Lam Dr David Moffat <b>Plenary 1</b>	Those keen young radiologists and endoscopists and their long needles: Cytology of the Retroperitoneum – The Final Frontier Dr Peter Bethwaite Brain Smears made easy Dr Tom Robertson How to avoid false negatives in cervical cytology: Detecting difficult high grade lesions Prof Annabelle Farnsworth <b>103   Chair: Dr Ian Clark</b>	Case Presentations - Trouble shooting in Biochemistry Elevated alkaline phosphatase in pregnancy: physiological or pathological? Dr Kay Weng Choy Laquelle est la vraie? Dr Christina Trambas Insulin: friend or foe Dr Aaron Simpson Why knowing your ABC is important when monitoring immunosuppressants Ms Kirsty Whenan Ms Talia Novos <b>105   Chair: Dr Penelope Coates</b>	Trainee Presentations Upside down death Dr Kirsty Andrews Diagnostic genetic and social considerations relating to mitral valve prolapse Dr Gregory Young Medicolegal aspects of Connective Tissue Disorders associated with Aortic Dissection Dr Victoria Francis <b>106</b> <b>Chair: Dr Chris Lawrence</b>
12.00pm - 1.00pm	Lunch on Level One amongst the Industry Exhibition and Roche Scientific Poster Display			
1.00pm - 2.00pm	<b>Innovations Plenary</b> Lymphoma Genomics: How Might Next Generation Sequencing Penetrate Laboratory Practice? - Prof Randy Gascoyne <b>Plenary1   Chair: A/Prof Kevin Carpenter</b>			
2.00pm - 3.30pm	<b>Anatomical and Forensic Session</b> Examination of the cardiovascular system in adults Prof Mary Sheppard <b>Plenary 1</b> <b>Chair: A/Prof Neil Langlois</b>		Inappropriate pathology testing - is there really a problem? Dr Stuart Smellie Datamining in ICU Prof Rinaldo Bellomo <b>105</b> <b>Chair: Dr Que Lam</b>	<b>Forensic and Anatomical Session</b> Examination of the cardiovascular system in adults Prof Mary Sheppard <b>Plenary 1</b> <b>Chair: A/Prof Neil Langlois</b>
3.30pm - 4.00pm	Afternoon Tea on Level One amongst the Industry Exhibition and the Winners of the Roche Scientific Poster Display Announced.			
4.00pm - 5.00pm	My approach to liver biopsy in the cholestatic adult and child Prof Alastair Burt <b>Plenary 1</b> <b>Chair: Prof Yee Khong</b>		Changes in cancer patterns from widespread testing Colon Cancer Screening Prof Graeme Young Prostate Cancer A/Prof Declan Murphy <b>105</b> <b>Chair: Dr Alan McNeil</b>	Arrhythmogenic Right Ventricular Cardiomyopathy Prof Mary Sheppard Right ventricular pathology in pulmonary thromboembolism and athletes Prof Jo Duflou <b>106</b> <b>Chair: Dr Sarah Parsons</b>
5.00pm - 6.00pm	RCPA BEA DS Nelson and QAP Oral Presentations - Support your Trainees! 109   Chair: A/Prof Peter Stewart			
6.00pm - 7.30pm	Welcome Cocktail Party on Level One amongst the Industry Exhibition - Sponsored by DiaSorin			

Genetics	Haematology	Immunopathology	Microbiology
RCPA hosted Medical and Science Students Welcome Breakfast <b>103</b>			
Meet the Chief Examiner <i>Prof David Ravine</i> <b>101/102</b>	Meet the Chief Examiner <i>A/Prof Erica Wood</i> <b>109</b>	Meet the Chief Examiner <i>A/Prof William Sewell</i> <b>111/12</b>	New technologies Magnetic nanoparticles for pathogen detection - <i>Prof Pak-Leung Ho</i> Considerations for introducing automation into the Microbiology <i>Dr Gillian Wood</i> <b>110   Chair: Dr Robert Norton</b>
Morning Tea on Level One amongst the Industry Exhibition and Roche Scientific Poster Display			
<b>Genetics and Microbiology Session</b> The other genome: metagenomics in clinical practice <i>Prof Philip Hugenholtz</i> <i>Prof Mark Morrison</i> <b>101/102</b> <b>Chair: Dr Harsha Sheorey</b>	Complicated Transfusion Problems - Ask the expert <i>Dr Julie Wang</i> <i>Dr Allison Mo</i> <i>Dr Kobie Von Wielligh</i> Expert Panel: <i>Dr Chris Hogan, Dr Marija Borosak and Dr Sunelle Engelbrecht</i> <b>109</b> <b>Chair: Dr Zoe McQuilten</b>	Interactive Flow and Direct Immunofluorescence session Quality assurance and pitfalls of multiparameter flow cytometry <i>Mr Geoffrey Osborne</i> Flow cytometry - clinical cases <i>A/Prof William Sewell</i> Direct Immunofluorescence on renal and skin biopsies <i>Dr Tiffany Hughes</i> <b>111/12</b> <b>Chair: Mr Bob Wilson</b>	<b>Microbiology and Genetics Session</b> The other genome: metagenomics in clinical practice <i>Prof Philip Hugenholtz</i> <i>Prof Mark Morrison</i> <b>101/102</b> <b>Chair: Dr Harsha Sheorey</b>
Lunch on Level One amongst the Industry Exhibition and Roche Scientific Poster Display			
<b>Innovations Plenary</b> Lymphoma Genomics: How Might Next Generation Sequencing Penetrate Laboratory Practice? - <i>Prof Randy Gascoyne</i> <b>Plenary1   Chair: A/Prof Kevin Carpenter</b>			
Managing Mainstream Genomics Transitioning from Research to Clinical Utility - Lessons and Future perspectives <i>A/Prof Howard Slater</i> <i>Prof Graham Taylor</i> <i>A/Prof Roger Wilson</i> <i>Prof Robyn Ward</i> <b>101/102</b> <b>Chair: Prof Graeme Suthers</b>	Innovations - Advances in cellular therapies relating to haematological conditions Gene and Cell Therapy Update <i>Prof John Rasko</i> Cellular therapies <i>Prof David Gottlieb</i> <b>109</b> <b>Chair: Dr Mandy Davis</b>	Personalised Medicine In Autoimmune Diseases: Myth or Reality? - <i>Dr Marvin Fritzler</i> Immune responses in SLE <i>Dr Ren Fen Chen</i> New autoantibodies in childhood encephalitis - <i>A/Prof Russell Dale</i> <b>111/12</b> <b>Chair: Dr Tiffany Hughes</b>	Infection control: role of Microbiology lab Antibiotic Stewardship <i>Dr Peter Kelley</i> MALDI - TOF in Infection Control (VRE) <i>Dr Paul Griffin</i> Outbreak investigation (KPC) <i>Dr Lisa Chang</i> <b>110</b> <b>Chair: Dr Sasha Jaksic</b>
Afternoon Tea on Level One amongst the Industry Exhibition and the Winners of the Roche Scientific Poster Display Announced.			
Managing Mainstream Genomics - Knowing and showing quality: QC and the TGA Accreditation and Regulation of NGS - <i>Mr Andrew Griffin</i> QA Program <i>Dr Kumari Hallwirth-Pillay</i> <b>101/102</b> <b>Chair: A/Prof Howard Slater</b>	Hodgkin lymphoma: From discovery to clinical translation <i>Prof Randy Gascoyne</i> <b>109</b> <b>Chair: Dr Bronwyn Williams</b>	Genetic testing methodologies: an update <i>A/Prof Bruce Bennetts</i> Genetic testing for immunodeficiency diseases: the value of increasing pretest probability - <i>Dr Melanie Wong</i> <b>111/12</b> <b>Chair: Dr Stephen Adelstein</b>	Insights into local healthcare infection epidemiology from VICNISS surveillance <i>Prof Mike Richards</i> Clostridium difficile strains in Victorians - known and unknowns <i>Ms Marion Easton</i> <b>110</b> <b>Chair: Dr Brendan McMullan</b>
RCPA BEA DS Nelson and QAP Oral Presentations - Support your Trainees! <b>109</b>   Chair: A/Prof Peter Stewart			
Welcome Cocktail Party on Level One amongst the Industry Exhibition - Sponsored by DiaSorin			





# Saturday 22 February 2014 Scientific Program

Time	Anatomical	Chemical	Forensic	Genetics
8.00am - 9.00am	<b>Pathology Masterclass</b> My QC Kitchen Rules - with Masterchefs A/Prof Tony Badrick and Dr Graham Jones <b>105</b>   <b>Chair: A/Prof Peter Hickman</b>			
9.00am - 10.00am	<b>Eva Raik Plenary Lecture</b> The Pathologist: The patient's physician - Prof Wendy Erber <b>Plenary 1</b>   <b>Chair: A/Prof Peter Stewart</b>			
10.00am - 10.30am	<b>Morning Tea on Level One amongst the Industry Exhibition and Roche Scientific Poster Display</b>			
10.30am - 12.30pm	Inflammatory Dermopathology: A Survival kit for the Surgical Pathologists Short Course - Part 1 <i>Dr Steven D Billings</i> <b>Plenary 1</b> <b>Chair: Dr Chris Hemmings</b>	Troponin POCT in ED Point of Care troponin in a rural setting <i>Dr Philip Tideman</i> Point of Care troponin in the peripheral hospital <i>Prof Hans Schneider</i> Do POCT troponins offer any advantage to the ED? <i>Dr Martin Than</i> <b>105</b> <b>Chair: Ms Jill Tate</b>	<b>Forensic and Paediatric session</b> What's new in paediatric cardiothoracic surgery? <i>Prof Igor Konstantinov</i> Guide to examination of the cardiovascular system in paediatrics <i>Prof Mary Sheppard</i> Genetic cardiac disorders in SIDS and perinatal death <i>Dr Sarah Parsons</i> <b>106</b> <b>Chair: Dr Nick Manton</b>	Coming to grips with Bioinformatics <i>Dr Elaine Mardis</i> Case Presentations Gene discoveries in epilepsy and its co-morbidities by exome sequencing. <i>A/Prof Leanne Dibbens</i> Mitochondrial disease <i>Dr Alison Compton</i> <b>101/102</b> <b>Chair: Dr Melody Caramins</b>
12.30pm - 1.30pm	<b>Lunch on Level One amongst the Industry Exhibition and Roche Scientific Poster Display</b>			
1.30pm - 3.00pm	Inflammatory Dermopathology: A Survival kit for the Surgical Pathologists Short Course - Part 2 <i>Dr Steven D Billings</i> <b>Plenary 1</b> <b>Chair: Dr Rose Miller</b>	Best practice in primary care pathology – an evidence - based approach to influence laboratory testing in primary care FINE <i>Dr Stuart Smellie</i> Demand management and approaches to the rationalization of test requesting FINE <i>Dr Stuart Smellie</i> <b>105</b> <b>Chair: Dr Chris Florkowski</b>	<b>Forensic and Genetics combined</b> Investigation of cardiac death – how far can you go? How are families investigated and what can be learnt? <i>Prof Ingrid Winship</i> What is (technically) possible? <i>A/Prof Edwin Kirk</i> Pathogenic Vs non - pathogenic variants <i>A/Prof Paul James</i> <b>106</b> <b>Chair: Dr Sarah Parsons</b>	
3.00pm - 3.30pm	<b>Afternoon Tea on Level One amongst the Industry Exhibition and Announcement of the winner of the BD Pre-analytical Poster</b>			
3.30pm - 5.00pm	Neuropathology – Tumour and Non Tumour for Adults and Paediatrics. <i>A/Prof Michael Buckland</i> <i>Dr Barbara Koszyca</i> <b>Plenary 1   Chair: Dr Inny Busmanis</b> <b>Masterclass</b> Practical Photography for Pathologists - From macro to micro, and powerpoint to print. <i>Dr Amanda Charlton</i> <b>103   Chair: Dr Chris Hemmings</b>	If you are fat, it is not your fault <i>Prof Joe Proietto</i> Pharmacological and non - pharmacological GLP - 1 receptor stimulants <i>A/Prof Jerry Greenfield</i> <b>105</b> <b>Chair: Dr Cherie Chang</b>	The TRAGADY initiative and ten years of cardiac genetic investigation of SUDI and SIDS in New Zealand <i>A/Prof Warren Smith</i> Progress on the ANZSCD project <i>Prof Christopher Semsarian</i> Sudden Death <i>Prof Mary Sheppard</i> <b>106</b> <b>Chair: Dr Karen Heath</b>	Reporting Genomic Data Workshop - Discussion of reporting format and incidental findings <i>A/Prof David Amor</i> <i>Dr Mark Davis</i> <i>Prof David Ravine</i> <b>101/102</b> <b>Chair: A/ Prof Bruce Bennetts</b>
6.00pm - 7.00pm	<b>RCPA Annual Admission of New Fellows and Awards Ceremony - All Welcome Plenary 1 (See page 18 for all details)</b>			
7.30pm - 11.30pm	<b>Pathology Update 2014 Conference Dinner at the Melbourne Museum</b> <i>Melbourne Museum - 11 Nicholson St Carlton Melbourne (Coach service provided). (See page 18 for all details)</i>			



Haematology	Immunopathology	Microbiology	Oral & Maxillofacial
<b>Pathology Masterclass</b> My QC Kitchen Rule - with Masterchefs A/Prof Tony Badrick and Dr Graham Jones <b>105</b>   <b>Chair: A/Prof Peter Hickman</b>			
<b>Eva Raik Plenary Lecture</b> The Pathologist: The patient's physician - Prof Wendy Erber <b>Plenary 1</b>   <b>Chair: A/Prof Peter Stewart</b>			
<b>Morning Tea on Level One amongst the Industry Exhibition and Roche Scientific Poster Display</b>			
Biology of Diffuse Large B Cell Lymphoma <i>Prof Randy Gascoyne</i> New diagnostic strategies for assessment of amyloidosis and myeloma <i>A/Prof Peter Mollee</i> <b>109</b> <b>Chair: Dr Ellen Maxwell</b>	Autoantibody Testing and Applications: Towards a New Orthodoxy <i>Dr Marvin Fritzler</i> New techniques in autoantibody testing; will it revolutionise testing? <i>Prof Thomas Gordon</i> Auto antibodies - of mice and men <i>Dr Katrina Randall</i> <b>111/12</b> <b>Chair: Dr Tiffany Hughes</b>	CNS infections Update on CJD <i>Prof Colin Masters</i> Update on Hendra virus and other Australian viruses <i>A/Prof Geoffrey Playford</i> Radiological diagnosis of CNS infections <i>Dr Tom Sutherland</i> <b>110</b> <b>Chair: Dr Joan Faoagali</b>	Forensic Odontology Scope of Practice <i>Dr Richard Basset</i> <i>A/Prof Jane Taylor</i> Age estimation/dental development and CT analysis <i>Dr Jeremy Graham</i> <b>103</b> <b>Chair: A/Prof Jane Taylor</b>
<b>Lunch on Level One amongst the Industry Exhibition and Roche Scientific Poster Display</b>			
<b>Coagulation Session</b> Monitoring of NOACs and management of bleeding issues <i>Dr Simon McRae</i> Use of POCT to guide management of complex coagulopathies - (ROTEM) <i>Prof John Fraser</i> <b>109</b> <b>Chair: Dr Tim Brighton</b>	Trainee Case Presentations Treatment resistant psychosis - an open and shut gate <i>Dr Dinusha Chandratilleke</i> Honey Induced Oral Allergy Syndrome <i>Dr Yang Tran</i> A Couple of Rats <i>Dr Shane Kelly</i> A Validation of the PLA2 Receptor Antibody ELISA in Primary Membranous GN <i>Dr Lawrence Ong</i> <b>111/12</b>   <b>Chair: A/Prof William Sewell</b>	Molecular Diagnosis workshop Basic molecular diagnosis for dummies and introduction to various technologies and platforms <i>Dr Scott Bowden</i> Bacterial resistance testing <i>Prof Jon Iredell</i> Mycobacteria diagnosis <i>Dr David Leslie</i> <b>110</b> <b>Chair: Dr Mary-Jo Waters</b>	
<b>Afternoon Tea on Level One amongst the Industry Exhibition and Announcement of the winner of the BD Pre-analytical Poster</b>			
Unusual paediatric conditions - laboratory to bedside <i>Dr Pauline Higgins</i> <i>Dr Tracey Batt</i> <i>Dr Bryony Ross</i> <b>109</b> <b>Chair: Dr Bronwyn Williams</b>	IgG subclasses <i>A/Prof David Fulcher</i> Assessing the function of basophils <i>Dr Alexander Headley</i> Assessing plasmablasts as a marker of immune competence <i>Dr Liz da Silva</i> <b>111/12</b> <b>Chair: Dr Katrina Randall</b>	Molecular Diagnosis workshop cont'd Diagnosis of STIs <i>Dr Darren Jardine</i> Parasitic diagnosis <i>Mr Colin Pham</i> Fungal diagnosis <i>A/Prof Sharon Chen</i> <b>110</b> <b>Chair: Dr Mary-Jo Waters</b>	
<b>RCPA Annual Admission of New Fellows and Awards Ceremony - All Welcome Plenary 1 (See page 18 for all details)</b>			
<b>Pathology Update 2014 Conference Dinner at the Melbourne Museum</b> Melbourne Museum - 11 Nicholson St Carlton Melbourne (Coach service provided). (See page 18 for all details)			

# Sunday 23 February 2014 Scientific Program

Time	Anatomical	Chemical	Forensic	Genetics
8.30am - 9.30am	<b>Pathology Masterclass</b> Mindfulness: why attention matters <i>Dr Craig Hassed</i> <b>109   Chair: Dr Brendan McMullan</b>			
9.30am - 10.30am	Pathology Innovations Making Cancer Genomics Personal <i>Dr Elaine Mardis</i> <b>Plenary 1   Chair: Prof Graeme Suthers</b>			
10.30am - 11.00am	<b>Morning Tea on Level One amongst the Industry Exhibition and Roche Scientific Poster Display</b>			
11.00am - 12.30pm	Vascular Lesions <i>Dr Steven D Billings</i> Melanocytic Lesions <i>Dr Steven D Billings</i> <b>Plenary 1</b> <b>Chair: Dr Michael Dray</b>	Vitamin D Debate- To D or not to D – is there a role in the laboratory measurement of 25-hydroxyvitamin D in patients who require to take califerol treatment <i>For - Dr Paul Glendenning</i> <i>Against - Dr Michael Crooke</i> <b>105</b> <b>Chair: A/Prof Tony Badrick</b>	Sudden death in young athletes <i>Dr Sarah Parsons</i> Pathology of Sudden Death in Epilepsy (SUDEP) <i>Dr Linda Iles</i> Investigation of Sudden Death in Epilepsy (SUDEP) <i>Prof Terry O'Brien</i> <b>106</b> <b>Chair: Dr Clive Cooke</b>	Decoding ENCODE: the clinical relevance of non - coding variants <i>A/Prof Marcel Dinger</i> <i>Dr Stefan White</i> <b>101/102</b> <b>Chair: Prof Hamish Scott</b>
12.30pm - 1.30pm	<b>Lunch on Level One amongst the Industry Exhibition and Roche Scientific Poster Display (Forum for the Fellows 1.00-1.30pm) - 105</b>			
1.30pm - 3.00pm	A memorable mistake and what it taught me <i>Dr Steven D Billings</i> <i>Dr Clive Cooke</i> <i>Prof Randy Gascoyne</i> <i>Prof Mary Sheppard</i> <i>Prof Graeme Suthers</i> <b>Plenary 1</b> <b>Chairs: Dr Chris Hemmings</b> <b>Dr Amanda Charlton</b>	Harmonisation of test profiles and retesting intervals in the UK FINE <i>Dr Stuart Smellie</i> Review of the NZ schedule: what tests should be supported? <i>Dr Cam Kyle</i> <b>105</b> <b>Chair: Dr Que Lam</b>	The implanted cardiac electronic device: Coroner's closure <i>A/Prof Harry Mond</i> QAP Review <i>Dr Noel Woodford</i> <b>106</b> <b>Chair: Prof David Ranson</b>	Ensuring clinical validity <i>Dr Elaine Mardis</i> <i>Dr Janice Fletcher</i> <b>101/102</b> <b>Chair: Dr Melody Caramins</b>
3.00pm - 4.00pm	<b>Rôse and Sparkling Closing Drinks on Level One amongst the Industry Exhibition and Roche Scientific Poster Display</b>			

Haematology	Immunopathology	Microbiology	Oral & Maxillofacial
<b>Pathology Masterclass</b> Mindfulness: why attention matters <i>Dr Craig Hassed</i> <b>109   Chair: Dr Brendan McMullan</b>		<b>7.30am - 10.30am</b> Microbiology Off Site Exam at Melbourne University <i>Dr Sasha Jaksic &amp; Dr Robert Norton</i> <i>(A Sita Coach will outside the the Hilton/Convention Centre Coach Bay at 7.30am and will bring delegates back at 10.3am. Dr Kathy Robinson will accompany the delegates).</i>	
Pathology Innovations Making Cancer Genomics Personal <i>Dr Elaine Mardis</i> <b>Plenary 1   Chair: Prof Graeme Suthers</b>			
<b>Morning Tea on Level One amongst the Industry Exhibition and Roche Scientific Poster Display</b>			
Grey Zone lymphomas <i>Prof Randy Gascoyne</i> CLL - An integrated approach to diagnosis and prognosis <i>Prof Stephen Mulligan</i> <b>109</b> <b>Chair: A/Prof Merrole Cole-Sinclair</b>	The Value of Autoantibody Testing in a Central Triage System <i>Dr Marvin Fritzler</i> Lab Tests Online – A resource for Immunology tests <i>Ms Louise Wienholt</i> Auto antibodies: Has External Quality Control led to better standardisation? <i>Ms Sue Jovanovich</i> Autoantibody standardisation at the coal face <i>Dr Kate Nicholls</i> <b>111/12</b> <b>Chair: Dr Tiffany Hughes</b>	Update on CNS infections Fungal infections - update on Cryptococcus <i>A/Prof Sharon Chen</i> Paediatric Angiostrongylus cases <i>Dr Philip Britton</i> Parasitic infections (soil amoeba) <i>Dr Jenny Robson</i> <b>110</b> <b>Chair: Dr Brendan McMullan</b>	Research topics in oral squamous cell carcinoma Bone invasion in squamous cell carcinoma <i>Prof Newell Johnson</i> The tumour microenvironment in oral squamous cell carcinoma <i>Prof Alison Rich</i> Epidemiologic differences of oral squamous cell carcinoma in New Zealand and Fiji <i>Dr Osea Gavidì</i> <b>103</b> <b>Chair: Prof Jane Dahlstrom</b>
<b>Lunch on Level One amongst the Industry Exhibition and Roche Scientific Poster Display (Forum for the Fellows 1.00-1.30pm) - 105</b>		<b>Meet the Chief Examiners Microbiology (12.30pm-1.30pm)</b> <b>Dr Sasha Jaksic &amp; Dr Robert Norton - 110</b>	
The role of flow cytometry in myeloid malignancies <i>Dr David Westerman</i> Clinical implications of gene mutation testing in AML <i>Dr Andrew Wei</i> <b>109</b> <b>Chair: Dr Huong Phan</b>	Technological Advances in Immunology Diagnostics Newer Autoantibody Testing Technologies and Diagnostic Platforms <i>Dr Marvin Fritzler</i> ISAC testing in diagnosis of Allergic Disease <i>Dr Karl Baumgart</i> Imaging Flow Cytometry: General Principles and Latest Applications <i>Mr Geoffrey Osborne</i> <b>111/12</b> <b>Chair: Dr Kate Nicholls</b>	Eye Infections Collection of specimen & IO treatment <i>Prof Penny Allen</i> Lab management of eye specimen <i>A/Prof Mary-Jo Waters</i> Parasitic infections of the eye <i>Dr Harsha Sheorey</i> <b>110</b> <b>Chair: Dr Chris Hewison</b>	Case reports <i>Dr Namita Mittal</i> <i>Dr Norman Firth</i> <i>Prof Richard Logan</i> <i>Dr Anna Talacko</i> QAP Review 2012 <i>Dr Michael Aldred</i> <b>103</b> <b>Chair: Prof Richard Logan</b>
<b>Rôle and Sparkling Closing Drinks on Level One amongst the Industry Exhibition and Roche Scientific Poster Display</b>			

# Pathology Update 2014 Floor Plan

## - Level One

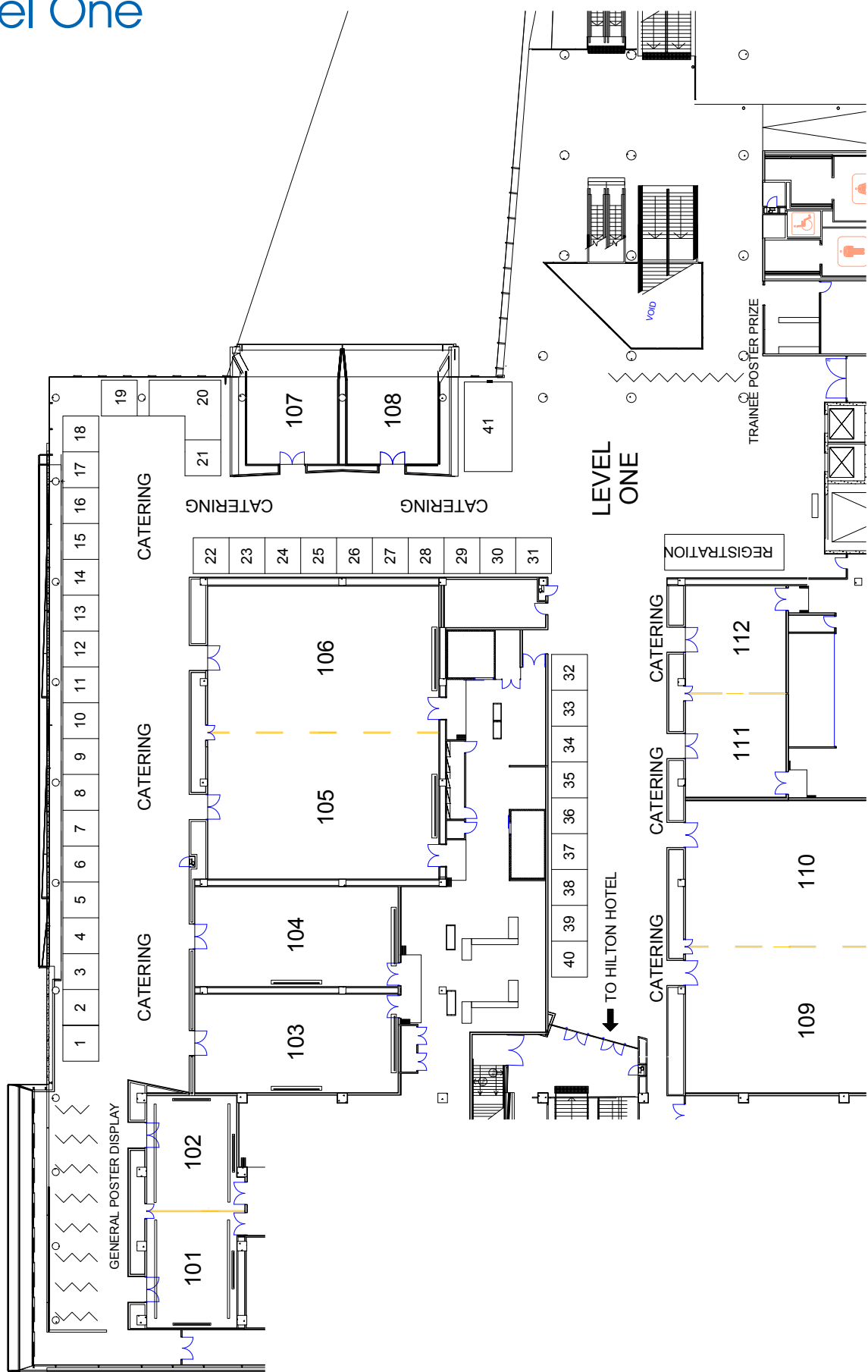

## MCEC venue locality



**Melbourne Convention and Exhibition Centre**  
1 Convention Centre Pl,  
South Wharf 3006

**Exhibition Centre entrance**  
2 Clarendon St,  
South Wharf 3006

- Tramline
- 96 Tram Number
- P Parking
- South Wharf Precinct

## MCEC directions

### Arriving by taxi:

Melbourne Convention and Exhibition Centre  
1 Convention Centre Place, South Wharf 3006

### Arriving by tram:

Tram numbers 96, 112 and 109 travel down Clarendon Street and stop at the entrance to the Melbourne Exhibition Centre. Walk down the concourse of the exhibition centre to the new Melbourne Convention Centre.

Tram numbers 48 and 70 stop at the end of Flinders Street, past Spence Street intersection. Walk to the new Melbourne Convention Centre via the new pedestrian footbridge across the Yarra.

### Arriving on foot:

Walk along the concourse of the exhibition centre or across the new pedestrian footbridge.

### Parking:

Available underneath the Melbourne Exhibition Centre, entrance off Normanby Road.

Above ground parking available adjacent to the New Melbourne Convention Centre, entrance off Normanby Road.



# Diagnosis BY THE YARRA

## PATHOLOGY UPDATE 2015

Friday 27 February – Sunday 1 March 2015

Melbourne Convention Centre  
South Wharf, Melbourne



[www.rcpa.edu.au](http://www.rcpa.edu.au)





## Pathology Update 2014 – Melbourne and the Masters

The Royal College of Pathologists of Australasia  
Durham Hall - 207 Albion St Surry Hills NSW 2010 AUSTRALIA

**Eve Propper**  
Events and Sponsorship Manager  
p:+ 61 2 8356 5806  
f:+ 61 2 8356 5828  
e: [evep@rcpa.edu.au](mailto:evep@rcpa.edu.au)  
<http://www.rcpa.edu.au>

